

# Congratulations!

---

---

Congratulations on your decision to invest in an SX-V Security System by Interactive Technologies, Inc. The SX-V System is a supervised alarm system that should give you many years of reliable, trouble free protection and peace of mind. This manual will introduce you to the SX-V and instruct you in its use. Please keep this information for your future reference.

## Table Of Contents

---

---

<b>Central Processing Unit</b>	<b>Page 1</b>
<b>Touchpads</b>	
<b>Detection Sensors</b>	<b>2</b>
<b>Sirens</b>	<b>3</b>
<b>Understanding The Display</b>	<b>4</b>
<b>Protection Levels</b>	<b>5</b>
<b>Operating Instructions</b>	<b>6</b>
Access Code	
Arming & Disarming	
<b>What To Do If The System Will Not Arm</b>	<b>8</b>
Bypassing	
<b>Special Features</b>	<b>9</b>
Status Button	
Alarm Memory	
Temporary Access Code	
Duress Code	
Emergency Alarm Buttons	
<b>Hi-Tech Hardwire Touchpad w/alpha Numeric Display</b>	<b>11</b>
<b>How To Test Your System</b>	<b>19</b>
<b>Troubleshooting</b>	<b>21</b>
<b>Fire Safety</b>	<b>23</b>
<b>Your Home Plan</b>	<b>24</b>
<b>Alarm System Limitations</b>	<b>25</b>
<b>Sensor Location Chart</b>	<b>26</b>

# Central Processing Unit

---

The heart of your ITI SX-V System is the Central Processing Unit (CPU). Typically the CPU is placed in an out of the way area that is convenient for the user. The CPU system functions are controlled by signals from a Wireless Touchpad or from a Hardwire Touchpad and Display.

The CPU also monitors and responds to the incoming signals from the individual detection sensors in your home or business. These sensors can detect an intruder, fire or other emergency. The protection level that you select with a Touchpad will determine which sensors will be on guard at any particular time.

Not only does the CPU monitor these emergency signals, but it is constantly monitoring the test signals that are sent from most sensors several times a day. This emergency or trouble information will be shown on the CPU Display Panel and can be sent to a Central Station Monitoring Facility through your phone lines. When the Central Station staff receives the information from the CPU, they know not only whether it is an alarm or trouble report, but they know the exact sensor that caused the report. This way, when the authorities or service people respond, they can be told exactly which sensor sent the alarm signal or trouble call.

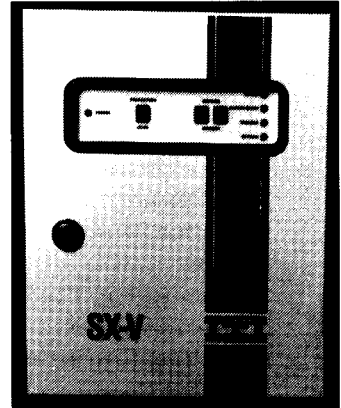

## Touchpads

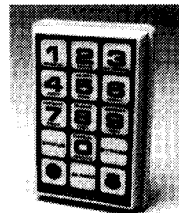
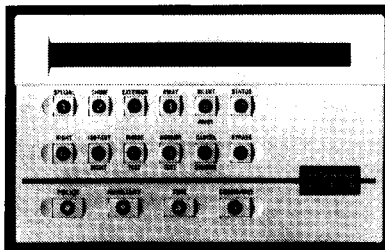

Your ITI SX-V Touchpads are used to give commands to the Central Processing Unit. The Wireless Touchpads can be used from anywhere in your home or business, as they are portable. With each Touchpad, there are several arming levels available, as well as built-in emergency buttons, test functions and a variety of other capabilities.

# Detection Sensors

---

Detection Sensors are used to sense Intrusion, Fire, Panic and Environmental alarms. ITI offers sensors for most every protection need.

## Door/Window Sensors ▼

These sensors detect the opening and closing of doors or windows. Special locations such as drawers, display cases, and firearms cabinets may also be protected with Door/Window Sensors.

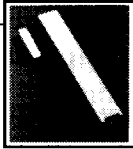

## Environmental Sensors ▼

A variety of temperature, furnace failure, and water detection sensors are available for complete environmental monitoring.

## Passive Infrared Motion Sensors ▼

Passive Infrared Sensors are designed to detect the body heat of an intruder who enters its field of view. In a home, Passive Infrared Sensors are usually used to protect valuables in the living room, dining room, or master bedroom area. In a business, Passive Infrared Sensors are strategically placed to protect valuable inventory, cash registers, safes and other areas.

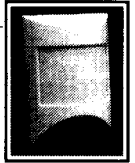

## Sounds Sensors ▼

Sound Sensors are designed to "hear" only the intense sounds caused by breaking glass or splintering wood if an intruder uses force to gain entry.

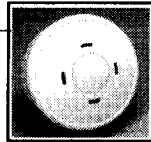

## Shock Sensors

Shock Sensors mount on window frames and detect the shock caused by an intruder who breaks through a window to gain entry.



## Smoke Sensors \*

Smoke Sensors should also be a part of your protection system. At a minimum it is desirable to have at least one smoke sensor on each floor level of a home and one outside all bedroom areas.

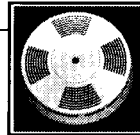

## Hand Held Panic Buttons

Portable Panic Buttons are small hand held devices that can send an emergency signal when pressed.



## Heat Sensors \* ▼

Heat Sensors are used to detect fire in areas not suited for Smoke Sensors, such as kitchens and garages.

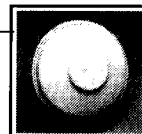

▼ - Not investigated by Underwriters Laboratories

\* - Please refer to the manufacturer's installation material, shipped with all fire sensors, for specific information regarding the national Fire Protection Association standards

# Sirens

---

## Interior Sirens

Interior Sirens (wired or wireless) can be placed in various locations to alert you of an emergency and frighten away an intruder. The following is a summary of the interior siren alarm sounds:

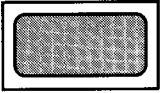

**EMERGENCY FIRE ALARM** - loud steady tone siren.

**EMERGENCY INTRUSION ALARM** - loud intermittent tone siren.

**AUXILIARY or ENVIRONMENTAL ALARM** - (Auxilliary is usually personal emergency) low volume, on-off-on-off beeping.

Many interior sirens also serve as status annunciators that provide an audible indication of the current protection level when the STATUS button is pressed. The following is a summary of the interior siren status sounds:

**PROTEST BEEPING** - low volume two-tone beeping sound which sometimes occurs when an attempt is made to arm the system. It indicates a low battery, a supervisory condition, or an open sensor.

**TROUBLE SUPERVISORY BEEPS** - six quick low volume beeps repeated once every 60 seconds which indicates a problem with the system. The sensor number window will display the sensor number(s) in trouble.

**CHIME TONES** - a pair of low volume tones which indicates a door or window sensor has been opened when the system is armed to level 2.

**SENSOR TEST SOUND** - loud single beep heard when testing the sensors in protection level 9.

## Exterior Sirens ▼

Exterior Sirens can be placed in various locations on the outside of your home or business to frighten away an intruder and alert you and your neighbors of an emergency. The Exterior Sirens can also be set with a 15 second delay before they sound an alarm. This allows you to turn off your system in the event of an accidental alarm before your neighbors are disturbed. The following is a summary of the exterior siren sounds:

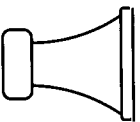

**EMERGENCY FIRE ALARM** - loud steady tone siren.

**EMERGENCY INTRUSION ALARM** - loud intermittent tone siren.

# Understanding The Display

---

Sensors in your SX-V System are monitored continuously by the CPU. Any Alarm, Supervisory, Trouble or Bypassed sensor will be shown on the CPU Display. If your system is connected to a Central Monitoring Station, the CPU will also notify the Central Station.

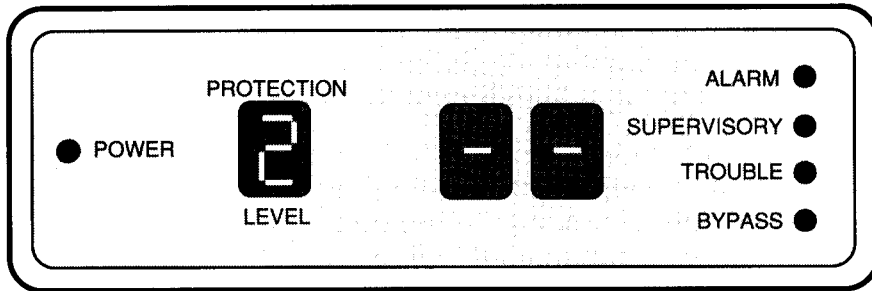

**POWER -** When on, AC power is on. When flashing, AC power has failed and the back-up battery is powering the system. When off, system is not operational.

**PROTECTION LEVEL -** The current protection level is displayed in this window.

**SENSOR NUMBER -** Sensors in alarm, open sensors, etc. will be displayed in the Sensor Number window.

**ALARM -** When an alarm is detected, the Alarm light will be on and the sensor in alarm will show in the Sensor Number window.

**SUPERVISORY -** Should a sensor stop working, the Supervisory light will be on and the problem sensor number will show in the Sensor Number window.

**TROUBLE -** Should a sensor's battery become low, the Trouble light will come on and the appropriate sensor number will show in the Sensor Number window. *It's important to replace low batteries immediately.* The Trouble light will also come on for trouble conditions in hardwired sensors.

**BYPASS -** If you bypass one or more sensors, the sensor number(s) will appear in the Sensor Number window and the Bypass light will be on. Remember, bypassed sensors do not provide protection.

# Protection Levels

---

The SX-V Security System can be armed to several different protection levels using a Touchpad. Each level, with corresponding status beeps, is designed to give you the specific amount of security you desire.



## **LEVEL "0" - DISARM/CANCEL** (1 Long Beep)

All burglary protection disarmed. All 24 hour detectors (fire, panic, and environmental) are armed in this protection level and in levels 1 through 8. Level 0 should also be selected to cancel an accidental alarm.



## **LEVEL "1" - SPECIAL** (1 Short Beep)

Your "SPECIAL" belongings are protected. Level 1 is used to protect the contents of safes, gun cabinets, silver cabinets, etc. This protection level remains on for all levels 1 through 7.



## **LEVEL "2" - CHIME** (2 Short Beeps)

A two beep "CHIME" tone will sound locally whenever an exterior door or window sensor is opened, no Central Station call is made.



## **LEVEL "3" - EXTERIOR** (3 Short Beeps)

All exterior door and window sensors will be armed. A delay period will allow you time to enter or leave the protected area. The delays will be active in levels 3 through 6.



## **LEVEL "4" - AWAY** (4 Short Beeps)

All sensors (both exterior and interior) will be armed. Delay times are active.



## **LEVEL "5" - SILENT/AWAY** (5 Short Beeps) \*\*

If your SX-V system is monitored by a Central Station, there may be times you wish to arm to level 5. All sensors will be armed as in level 4 with the delay times active, however in level 5, the sirens won't sound during a break-in. The system instead will silently call the Central Station and notify them of the emergency. The sirens will sound however, if there is a fire or panic alarm or if there is a break-in and the phone lines are not working. ***For personal safety reasons, never arm your system to level 5 if anyone is at home.***\*\* Level 5 shall not be used in U.L. Listed systems.

# Protection Levels

---



## **LEVEL “6” - NIGHT** (1 Long and 1 Short Beep)

For use at night while your family sleeps. The delay times are active to allow for a family member still coming home. All exterior and selected interior sensors are armed. Sensors in the bedroom and bath area are usually off in this level.



## **LEVEL “7” - INSTANT/NIGHT** (1 Long and 2 Short Beeps)

The same protection as level 6 except there are no entrance or exit delays. The system will sound an alarm instantly if any armed sensor detects an intruder.

This level is typically used at night after everyone is at home.

# Operating Instructions

---

## **ACCESS CODE**

The ACCESS CODE is your personal key to using the SX-V System. By entering this four-digit identification code on your Touchpad, you can select any of the protection levels, cancel accidental alarms, test your system, etc.

## **ARMING AND DISARMING**

First, close all protected doors and windows. Then enter your four-digit access code on your Touchpad, immediately followed by the number of the Protection Level desired. Listen for the correct number of Status beeps.



## **HOW TO ARM YOUR SYSTEM WHEN LEAVING HOME**

(All sensors armed.)

1. Enter your personal access code.
2. Press the “AWAY” (#4) button.
3. Listen for the “4 Short Beeps.”
4. If leaving, leave immediately.

The EXIT delay time is \_\_\_\_\_ seconds.



## **HOW TO ARM YOUR SYSTEM WHEN STAYING HOME**

(Perimeter sensors armed, interior off.)

1. Enter your personal access code.
2. Press the “EXTERIOR” (#3) button.
3. Listen for the “3 Short Beeps.”
4. If leaving, leave immediately.



## HOW TO TURN OFF YOUR SYSTEM WHEN ARRIVING HOME.

(System disarmed except for 24 hour sensors.)

1. Enter your personal access code.
2. Press the "DISARM" (#0) button.
3. Listen for the "1 Long Beep."

The EXIT delay time is \_\_\_\_\_ seconds.



## HOW TO ARM YOUR SYSTEM AT NIGHT , WITH A FAMILY MEMBER STILL COMING HOME (Night protection with delays.)

1. Enter your personal access code.
2. Press the "NIGHT" (#6) button.
3. Listen for the "1 Long and 1 Short Beep."



## HOW TO ARM YOUR SYSTEM AT NIGHT, WITH EVERYONE HOME

(Night protection with no delays.)

1. Enter your personal access code.
2. Press the "NIGHT/INSTANT" (#7) button.
3. Listen for the "1 Long and 2 Short Beeps."



## HOW TO ARM JUST THE SPECIAL INTRUSION SENSORS

1. Enter your personal access code.
2. Press the "SPECIAL" (#1) button.
3. Listen for the "1 Short Beep."



## HOW TO TURN ON THE CHIME FEATURE

(The CHIME tones sound when exterior sensors are opened.)

1. Enter your personal access code.
2. Press the "CHIME" (#2) button.
3. Listen for the "2 Short Beeps."



## HOW TO CANCEL AN ACCIDENTAL ALARM

(System disarmed except for 24 hour sensors.)

1. Enter your personal access code.
2. Press the "CANCEL" (#0) button.
3. Listen for the "1 Long Beep."



# What To Do If The System Will Not Arm

---

If you hear repeated, two-tone Protest beeps when you attempt to arm your system, it probably means that a door or window has been left open. If so, the number of the open door or window will flash in the CPU Display along with all four flashing red lights. The protest beeps can also mean that there is either a Trouble condition or a Supervisory problem. Failure to take action when the protest beeps are heard will leave your system unprotected.

## If You Hear Beeping Sounds

1. Look at the display window to see if a sensor is open or if there is a Trouble (usually low battery) or Supervisory problem.
2. If a sensor is open, close the door or window. The protest beeps will stop and you can arm the system.  
**If the CPU shows that a door or window is open, when in fact it is closed, then you must reopen and close that door or window to reset the CPU before rearming.**
3. If the display is indicating a problem, you must either fix the problem or BYPASS the problem. To temporarily BYPASS the problem, follow the steps given above.  
**If a Trouble or Supervisory condition exists and no arming change has occurred for 10 hours, the system will automatically sound six quick beeps every 60 seconds to inform you of the condition. To silence the beeps, change arming levels. Trouble and Supervisory conditions will be automatically reported to the Central Station.**

## Bypassing

It is possible to arm your system with a door or window purposely left open. This is known as **BYPASSING**. Bypassing means that the system will be armed to the protection level you choose, however, the sensor or sensors that you bypass will not provide protection until you change protection levels again. Bypassing a window sensor for example, allows you to open that window for fresh air and still have the security of the rest of the system. NOTE: Bypassing a sensor leaves that sensor unmonitored by the system

## How To Use Direct Bypassing

1. With all sensors closed, arm the system to the desired level.
2. Determine the number of the sensor you want bypassed.
3. • Enter your personal access code.  
• Press the BYPASS button.  
• Enter the two-digit sensor number you want bypassed.
4. A single beep will sound and the specific sensor will be bypassed.
5. You should verify that the correct sensor has been Bypassed by looking at an alarm display.

If you want to Direct Bypass more than one sensor, each must be bypassed one at a time by following steps 3 through 5. If you bypass sensors during an exit delay period, each time you bypass the exit delay time period begins again.

# Special Features

---

## Status Button

If you are not within sight of a display, you can determine your current protection level by simply pressing the STATUS button. Listen to and count the status beeps that sound. For example, if you hear 2 short beeps you know the system is armed to Level “2” Chime.

## Alarm Memory

If you are within sight of a display when you press the STATUS button, you can tell if there was an alarm during the previous arming period by watching to see if any sensor numbers appear on the display. If the display stays blank, there were no alarms. Any alarms in memory will be erased six hours after disarming the system. The alarm memory can be erased immediately by arming to level 9.

## Temporary Access Code

You can set a second access code for temporary use by a baby-sitter, repairman, etc. This code can be used to arm and change the protection levels of the system but cannot change to Level 0, 8 or 9 or for Direct Bypassing. It is recommended that the Temporary Access Code be set while in view of the CPU Display.

**WARNING:** The Temporary Access Code cannot be used to disarm to Level 0. Thus, you must teach temporary users to disarm to Level 1.

### How to set the Temporary Access Code.

1. Enter your personal access code.
2. Press the STATUS button.
3. Enter the desired four-digit Temporary Access Code.
4. Watch for the “Bouncing Balls” in the CPU Display and listen for the single beep. This indicates acceptance.

### How to turn off the Temporary Access Code.

1. Enter your Personal Access Code.
2. Press the STATUS button.
3. Enter your Personal Access Code again.
4. Watch for the “Bouncing Balls” in the CPU Display and listen for the single beep.

**NOTE:** The Primary Access Code can be changed only by your servicing ITI Dealer.

## Duress Code

If your system is monitored by a Central Station, you can take advantage of the Duress Code. This code must be set by your authorized ITI dealer. Your Duress Code works exactly like your regular access code except that, in addition to changing the Protection Level, it also sends a silent, emergency signal to the Central Monitoring Station. By using the Duress Code you can notify the Central Station secretly and silently of an emergency. For your safety, the Duress Code will not display when in alarm.

### How to use the Duress Code.

1. Enter your special four-digit Duress Code.
2. Select any protection level.

**WARNING:** Be sure to never confuse your Duress Code with your personal access code because a Duress Code cannot be cancelled.

## Emergency Alarm Buttons

If you have an emergency you can sound the sirens and notify the Central Monitoring Station by pressing the emergency buttons on your Touchpad.



### How to signal an emergency with the Wireless Touchpad or with the Hardwire Touchpad.

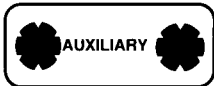

- Press both POLICE buttons at the same time and hold for 1 second
- or**
- Press both AUXILIARY buttons at the same time and hold for 1 second,
- or**



- Press both FIRE buttons at the same time and hold for 1 second.

**NOTE:** The police and auxiliary emergency functions are not provided in U.L. Listed systems when the 60-101 Touchpad is used.



### How to signal an emergency with a Hand Held Wireless Touchpad.

- Press both the POLICE button and the ALARM button at the same time and hold for 1 second,
- or**
- Press both the AUXILIARY button and the ALARM button at the same time and hold for 1 second.

**NOTE:** The emergency functions from the Hand Held Wireless Touchpad are not provided in U.L. Listed systems.

# Hi-Tech Hardwire Touchpad w/alpha Numeric Display

The optional Hardwire Touchpad with Alpha Numeric Display can be custom programmed by your installing dealer to suit the configuration of your SX-V system. The current status of any sensor can be shown on the display by its number and name for easy identification.

In addition to displaying sensor names, the touchpad also gives you these conveniences:

- 4 Display Dimming Levels
- Backlit Buttons For Easy Night Viewing
- Quick Arm Option Using COMMAND Button
- Single Button Panics For Police, Auxiliary and Fire Alarms

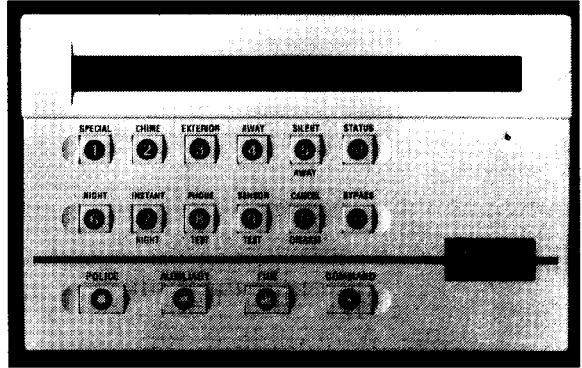

ITI PART NO. 60-248  
Not Investigated By U.L.

## Display Message

After arming the system to levels 3-6, the touchpad will briefly display an exit message and then show the Protection Level number and name.

For example,

- Arming to Level 4 will look like this:

**4-OK TO EXIT NOW**

then

**4-AWAY**

- Arming to Level 7 will look like this:

**7-GOOD NIGHT**

then

**7-INSTANT NIGHT**

- If a sensor is tripped during an armed period, the display may look like this:

**EXTERIOR ALARM**

- Pressing the **ST** (STATUS) button once will show the tripped sensor number and its name.

**40 ALARM-DEN DOOR**

- Enter your Access Code + 0 to cancel the alarm and disarm the system. The display will read:

**0-DISARMED**

## Alarm Memory

After the system is disarmed, the alarm information can be reviewed by pressing **ST** 2 times. Referring to the example on the previous page, the display would show the following Alarm Memory information:

**40 MEMORY-DEN DOOR**

## System Status

The Protection Level number at the left of the display will flash to indicate that one or more of the following conditions exist:

ALARM CONDITION	BYPASSED SENSOR
ALARM IN MEMORY	TROUBLE
OPEN SENSOR (Optional)	SUPERVISORY

Anytime the Protection Level number is flashing, press the **ST** button once and the display will show the sensor number, its condition and the sensor's name.  
For example:

**40 OPEN-DEN DOOR**

- Press the **ST** button 2 times and the display will always show any Alarm Memory information and the current Protection Level of the system.

## Phone Test

After performing a Level 8 Phone Test (from any touchpad), the Quick Arm feature is temporarily disabled. You must use your Access Code with the first command after a Phone Test. This will enable the Quick Arm feature to function again.

## Sensor Test

During a Level 9 Sensor Test, the touchpad will emit a *beep* and display the "tripped" sensor's number and name. After all sensors have been tripped (including touchpad panics) and acknowledged, the display will read:

**9-SENSOR TEST OK**

1. Enter your Access Code + 0 to exit Level 9 and disarm the system.  
If you forget to exit Level 9, the system will automatically disarm to Level 0 on its own after 15 minutes in Level 9.

# Quick Reference

## LEVEL 4 - AWAY

CODE + 4 or COMMAND + 4\*

All sensors armed.

## LEVEL 3 - EXTERIOR

CODE + 3 or COMMAND + 3\*

24 hour, Special and Exterior sensors (34-57) armed.

## LEVEL 2 - CHIME

CODE + 2 or COMMAND + 2\*

24 hour and Special sensors armed.  
Exterior sensors chime when tripped.

## LEVEL 1 - SPECIAL

CODE + 1 or COMMAND + 1\*

24 hour and Special sensors(30-33) armed.

## LEVEL 6 - NIGHT

CODE + 6 or COMMAND + 6\*

All sensors armed except 64-65 & 73-74.

## LEVEL 7 - INSTANT NIGHT

CODE + 7 or COMMAND + 7\*

Same as Level 6 except No Delay on sensors 34-37.

## LEVEL 8 - PHONE TEST

CODE + 8

Tests the communication from your system to the central monitoring station.

## LEVEL 9 - SENSOR TEST

CODE + 9

Tests the communication from sensors to the control panel.

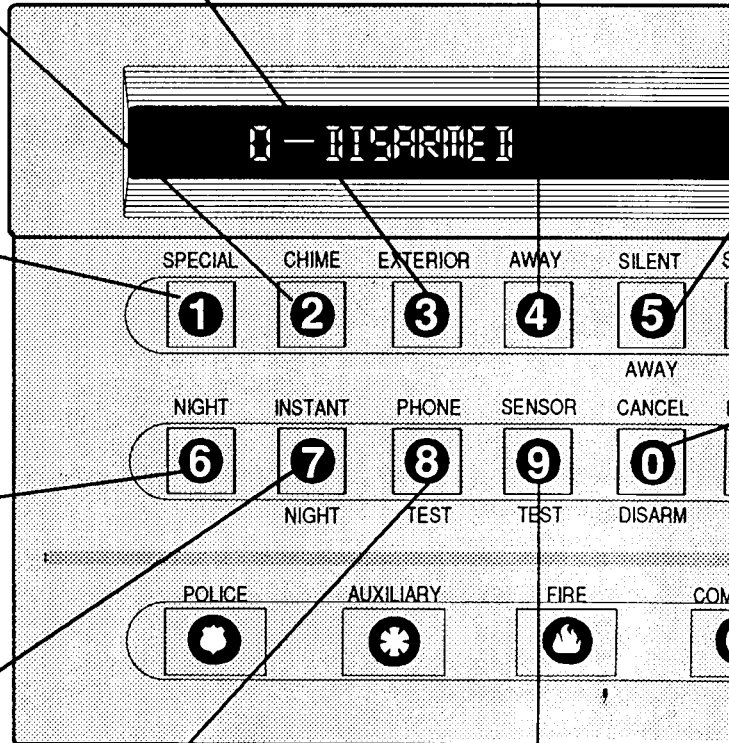

ND + 4\*

\* Quick Arm feature must be programmed and current Protection Level must be 0, 1 or 2.

**LEVEL 5 - SILENT AWAY**

CODE + 5 or COMMAND + 5\*  
All sensors armed but no siren sounds for Burglary alarms.

**STATUS**

Press once to read condition messages. Press twice to read Alarm Memory information and current Protection Level.

**LEVEL 0 - DISARM**

CODE + 0  
Disarms all sensors except for 24 hour sensors.

**BYPASS**

Used to Bypass specific sensors while leaving other sensors armed. Refer to your SX-V owner's manual for Bypass procedures.

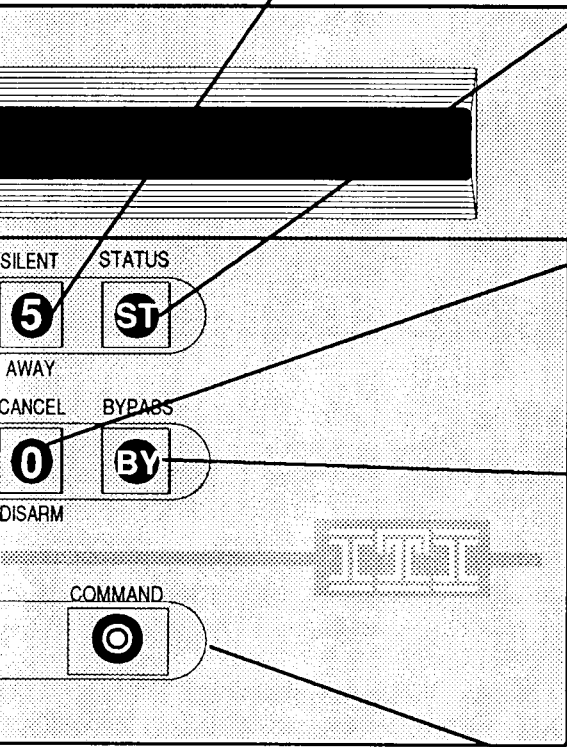

24 Hour Police Panic: Press and hold until sirens sound.



24 Hour Auxiliary Panic: Press and hold until sirens sound.



24 Hour Fire Panic: Press and hold until sirens sounds.



Command: Quick Arm (If Programmed)  
Display Dimming

**TEST**

n from  
anel.

## Indirect Bypassing

This procedure is the same as the one described in your SX-V Owner's Manual. However, the touchpad must be displaying the main protest message (#2 below) when the Bypass button is pressed in order to perform a successful Indirect Bypass. See the example below.

1. Open sensor 50, East Window.
2. Enter your Access Code + 4. The display will show:

**0-DISARMED**

then

**0-PROTEST**

3. Press **BY** and the display will show:

**4-OK TO EXIT**

then

**4-AWAY**

4. The Protection Level number will flash to indicate the system is armed with a sensor bypassed.

While the system is protesting, pressing the **ST** button once will display the protesting sensor. Using the example above, the display would show:

**50 OPEN EAST-WINDOW**

Only after the touchpad returns to the main protest message (#2 above) will pressing the Bypass button perform a successful Indirect Bypass.



## Panic Buttons

The 3 panic buttons located on the lower part of the touchpad allow any user to manually trip an audible Police, Auxiliary or Fire alarm. The panic buttons are active 24 hours a day and can be used with the system set to any level except Level 9 (Sensor Test).

1. Press and hold the  button until you hear the touchpad emit 6 rapid beeps. All Interior and Exterior sirens will emit a slow ON OFF ON OFF alarm sound. The display will read as follows:

**POLICE ALARM**

Enter your Access Code + 0 to cancel the alarm and turn off all sirens.

2. Press and hold the  button until you hear the touchpad emit 6 rapid beeps. All Interior sirens will emit a fast ON OFF ON OFF alarm sound. The display will read as follows:

**AUXILIARY ALARM**

Enter your Access Code + 0 to cancel the alarm and turn off all sirens.

3. Press and hold the  button until you hear the touchpad emit 6 rapid beeps. All Interior and Exterior sirens will emit a steady tone. The display will read as follows:

**FIRE ALARM**

Enter your Access Code + 0 to cancel the alarm and turn off all sirens.

# Temporary Access Code

The procedure for programming this code is the same, however the touchpad allows you to read your entry on the display.

1. Enter your Access Code, then press the  button.  
The display will read as follows:

**TEMP CODE** \_ \_ \_ \_

2. Now enter 4 digits, such as 5 7 6 8. After entering the fourth digit, all four numbers will flash for a few seconds, then the display will read as follows:



**TEMP CODE DONE**

3. The message above will be shown briefly before the display returns to show the current Protection Level.

## Quick Arm (Optional)

The COMMAND button allows any user to arm the system to the following levels:

**FROM:** Level 0 to Levels 1-7  
Level 1 to Levels 2-7  
Level 2 to Levels 3-7

**EXAMPLE:** With the system in Level 0, arm to Level 4 by pressing  then  .  
The display will show:

**4-OK TO EXIT NOW**

then

**4-AWAY**

## Quick Arm Limitations

- Once in Level 3, the system requires use of your Access Code to change the protection level.
- The COMMAND button does not lower the protection level or disarm the system.
- Sensor bypassing is not allowed when arming with the COMMAND button.
- Test levels 8 and 9 cannot be accessed using the COMMAND button.

The touchpad will emit an error tone consisting of *1 short beep followed by 1 long beep* if you attempt any of the above limitations or any other invalid command.

## Display Bypassing

Press and hold the COMMAND button and the display will dim from 100% to 75%, 50%, 25% or blackout. As long as the COMMAND button is pressed the dim levels will continue to cycle. Once you see the desired level, quickly release the COMMAND button.

Once a dim level is set, pressing any button will illuminate the display to full brightness. After 15 seconds of no touchpad activity, the display will return to the set dimmed level.

During an alarm condition, the display will automatically go to full brightness. Once the system is disarmed and there is 15 seconds of no touchpad activity, the display will return to the set dimmed level.

The Entry Delay time and a Level 9 Sensor Test will also force the display to full brightness. After disarming the system and no touchpad activity for 15 seconds, the display will return to the set dimmed level.

## Backlit Buttons

The buttons on the touchpad are backlit with a soft red light for easy night viewing. After 15 seconds of no touchpad activity, this lighting goes out. Press any key to illuminate the buttons.

## Other Display Messages

The following list of display messages may appear to alert you of certain conditions. Messages listed with an asterisk (\*) are optional features and may not pertain to your system. Check with your installing dealer about the configuration of your system regarding these messages.

00 BUDDY REPORT*	87 FORCED ARMED*
01 SENSOR IN RANGE	90 AC FAILURE*
77 TOUCHPAD TAMPER	91 LOW CPU BATTERY
80 FIRE ALARM	92 CPU TAMPER*
81 POLICE ALARM	93 AUTO PHONE TEST*
82 AUXILIARY ALARM	94 RECEIVER TROUBLE
83 PHONE TEST	95 CPU BACK IN SERVICE
84 OPENING REPORT*	96 FAILURE TO COMMUNICATE
85 CLOSING REPORT*	97 NO PHONE LINE

# How To Test Your System

---

To assure continued protection, all systems must be tested regularly. We recommend that you test your system at least once each week. The **SX-V System** has two testing levels that are easily accessed by first entering your personal access code and then the desired testing level.



## LEVEL "8" - PHONE TEST (1 Long and 3 Short Beeps)

**Level 8** tests the optional telephone communications link between your system and the Central Monitoring Station. The telephone communications link test is complete when the Central Station causes your interior and exterior sirens to sound their alarm sounds for a few seconds, or when the Central Station operator calls to verify the successful test. In addition, the display will change from Protection **Level 8** to Protection Level 0 when the test is complete.



## LEVEL "9" - SENSOR TEST (1 Long and 4 Short Beeps)

**Level 9** is used to test the communications between the detection sensors and the CPU. When in **level 9**, the display will automatically scroll the numbers of every sensor in your system. During this test, trip each sensor that is a part of your system. As the CPU receives an "OK" signal from each sensor, its number is removed from the display scroll and the interior sirens will sound a short loud beep. (The exterior sirens do not activate during this test.) The test is complete when all sensors have been tested and no numbers are displayed on the CPU. If any sensor numbers remain in the display, retest those sensors. If any sensor does not test properly, immediately call your authorized ITI dealer for service.



### How to test your Door/Window Sensors. (Model 60-135)

1. Open each protected door, window, cabinet, etc.
2. Listen for the siren beep.
3. Close the door or window.



### How to test your Passive Infrared Motion Sensor. (Model 60-104) ▼

1. Stay out of the viewing area of each P.I.R. for **4 full minutes**.
2. After 4 minutes walk in front of the sensor and listen for the siren beep.

▼ - Not investigated by Underwriters Laboratories.

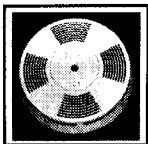

### How to test your Smoke Sensor. (Model 60-106)

Press and hold the test button on each Smoke Sensor for **20 to 30 seconds** until the alarm horn sounds and the red light glows steadily. It is recommended that you carefully vacuum the Smoke Sensor once or twice yearly.



### How to test your Hand Held Panic Buttons. (Model 60-149)

Press and hold both alarm buttons for 1 second. Do this for every Hand Held Panic Button that is part of your system.



### How to test the Touchpad Emergency Buttons.

1. Press both Emergency Police Buttons for 1 second (Sensor # 81).
2. Press both Emergency Auxiliary Buttons for 1 second (Sensor # 82).
3. Press both Emergency Fire Buttons for 1 second (Sensor # 80).

Your Touchpad may not have emergency Fire buttons. If not, sensor number 80 may remain on the display. This is normal.

### How to test Specialized Sensors.

Specific instructions vary on how to test other sensors such as: Sound Sensors, Shock Sensors, Heat Sensors, and Environmental Sensors. Consult your alarm dealer for testing procedures for these sensors.

### Additional notes about Testing.

While in level 9, the CPU automatically disconnects itself from AC power and operates on its own battery. This assures testing of the stand-by battery power supply. If the battery were to fail this test, the problem would be reported to the Central Station and a 91 ALARM would appear on the display.

The CPU will automatically select Protection Level 0 fifteen minutes after Level 9 has been selected. This will restore basic protection in the event you forget to leave Level 9 when your testing is complete.

# Troubleshooting

---

## AC Power Failure

Your CPU has an emergency back-up battery that can last 48 to 72 hours during a power failure. When the power returns the batteries will automatically recharge themselves.

During an AC power failure the Power Light will flash on and off to indicate the back-up battery is functioning properly. After about 15 minutes without AC power, the rest of the display will go blank to conserve the battery power.

If you want to know your protection level during a power failure, simply press the Status button. The display will light momentarily and the protection level status beeps will sound.

## Smoke Sensor Low Battery Indication

The ITI Smoke Sensor contains its own low battery detector and annunciator. A low battery condition will cause the Smoke sensor's annunciator to beep. (The smoke sensor low battery beeping may occur before the CPU display shows a low battery condition.) *Low batteries should be replaced immediately as failure to do so will adversely affect the smoke sensor's ability to function properly.*

**NOTE:** Replace batteries one at a time. Failure to do so will require your servicing dealer to reprogram the smoke sensor.

## Disrupted Telephone Service

When your security system is monitored by a Central Monitoring Station, your CPU will be connected to your phone system. In the event you should find that your telephone does not work, unplug the SX-V from its special phone jack. If your telephone still does not work, the problem is in the telephone system and not with your SX-V System.

**WARNING:** The SX-V must be plugged back into its special phone jack to provide alarm communications.

## Options

The SX-V security system is modular. This allows you to customize the protection for your home or business. All of the detection sensors, touchpads, fire sensors, etc. are optional. Many of the features of the CPU, including Central Station monitoring, the duress code, etc. are also optional. Ask the dealer who installed your system if you have any questions as to the exact protection provided by your system.

## Major System Failure

Although it is unlikely, should your system become disabled the CPU panel Main Power Switch should be turned off. Open the panel door. The switch is located in the lower center of the circuit board. Push the switch down to turn off the system. It is important to contact your authorized ITI dealer immediately.

## Sensor Battery

Most SX-V Sensors have Lithium batteries that have a life expectancy of from 5 to 8 years. However, some sensors may be powered by 9 volt DC alkaline batteries that will need to be replaced about every 1 to 2 years. When one sensor's alkaline battery gets weak, it's a good practice to replace the alkaline batteries in all sensors.

The **60-106** Smoke Sensor, **60-149** Panic Transmitter, **60-104** PIR Motion Sensor and **60-149** Portable Panic Sensors use alkaline batteries manufactured by Duracell, MN1604.

The **60-135** door/window transmitter and **60-101** Touchpad use Lithium batteries manufactured by SAFT (p/n LS-3) or Tadiran (p/n TL515/S).

## FCC Compliance

Equipment manufactured by Interactive Technologies, Inc. has been tested and is in compliance with FCC Rules, Part 15, Subpart J and E and Part 68 where applicable. Each device carries a label giving the specifics and conditions of compliance.

## Warranty

Interactive Technologies, Inc. extends a warranty to its wholesale dealers who buy direct from ITI. ITI does not warrant its products to consumers. Consumers should ask the dealer who installed their system the nature and extent of the dealer's warranty, if any. There are no obligations or liabilities on the part of ITI for consequential damages arising out of or in connection with the use or performance of these products. ITI makes no guaranty or warranty, including any implied warranty of merchantability or fitness regarding these products.

## Service

If you have any questions about your SX-V System, or if you ever need service, please contact the local ITI dealer who installed your system.

PHONE No. \_\_\_\_\_

ADDRESS \_\_\_\_\_

# Fire Safety

**NOTE:** Ceiling mounted smoke detectors should be located in the center of the room or hall, or not less than 4 inches from any wall. When the detector is mounted on a wall, the top of the detector should be 4 to 12 inches from the ceiling

**NOTE:** Do not install smoke detectors where normal ambient temperatures are above 100° F or below 40° F. Also do not locate detectors in front of AC/Heat registers or other locations where normal air circulation will keep smoke from entering the detector.

**NOTE:** Additional information on household fire warning is available at nominal cost from: The National Fire Protection Association, Batterymarch Park, Quincy, MA 02269. Request Standard No. NFPA74.

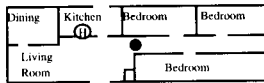

*Smoke detectors should be located between the sleeping area and the rest of the family living unit.*

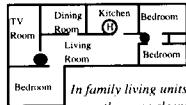

*In family living units with more than one sleeping area, a smoke detector should be located at each area.*

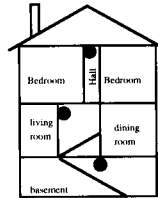

A smoke detector should be located on each level.

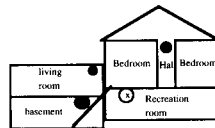

● Required smoke detector

⊙ Indicates smoke detector is optional if door is not provided between ceiling and recreation rooms.

Ⓜ Heat Detector

1. Draw a floor plan of your home in the space provided above. Make sure to show the exits from each room (two exits per room are recommended by UL).

2. Hold a discussion on family emergency procedures which includes the following:

- A. Status of bedroom doors.
- B. Familiarity with alarm system.
- C. Testing of doors during a fire and the use of alternate escape routes if hot to touch.
- D. Crawling and holding breath.
- E. Escape fast! No stopping for packing!
- F. Meet at a designated outdoor location.
- G. Emphasize that no one is to return to a burning house.
- H. Notify fire department from a neighbor's phone.

3. Periodic rehearsals should be conducted.

4. If you return home and hear the siren, do not enter the house. Call for the fire or police department based on the type of alarm condition provided.



# Your Home Floor Plan

---

---

# Alarm System Limitations

---

Not even the most advanced alarm system can guarantee protection against burglary, fire and other emergencies. All alarm systems are subject to possible compromise or failure-to-warn for a variety of reasons:

- If sirens or horns are not placed within hearing range of persons sleeping or in remote parts of the house. Warning devices may not be heard if they are placed behind doors or other obstacles, or on levels distant from areas frequently occupied by residents.
- If intruders gain access through unprotected points of entry or areas where sensors have been bypassed.
- If intruders have the technical means of bypassing, jamming or disconnecting all or part of the system.
- If freeze, water or other environmental sensors are not located in an area where they can detect an environmental problem.
- If power to detectors is discontinued or inadequate. Devices will not work if the AC power supply is off and back-up batteries are either missing, dead, or improperly installed.
- If smoke does not reach the sensor. Smoke sensors cannot detect smoke in chimneys, in walls or roofs, or smoke blocked by a closed door. They may not detect smoke or fire on a level of the building different from the one on which they are located. Sensors may not be able to warn in time about fires started by smoking in bed, explosions, improper storage of flammables, overloaded electrical circuits, or other types of hazardous conditions.
- If transmission lines are out of service. Transmissions from the CPU to a Central Monitoring Station cannot be made over lines that are out of service. Telephone lines are also vulnerable to compromise by any of several means.

Inadequate maintenance is the most common cause of alarm failure. Therefore, test your system at least once per week to be sure sensors, sirens, the communicator, etc. are all working properly.

Although having an alarm system may make you eligible for reduced insurance premiums, the system is no substitute for insurance. Warning devices cannot compensate you for loss of life or property.



**SECURITY  
SYSTEM  
OWNER'S  
MANUAL**

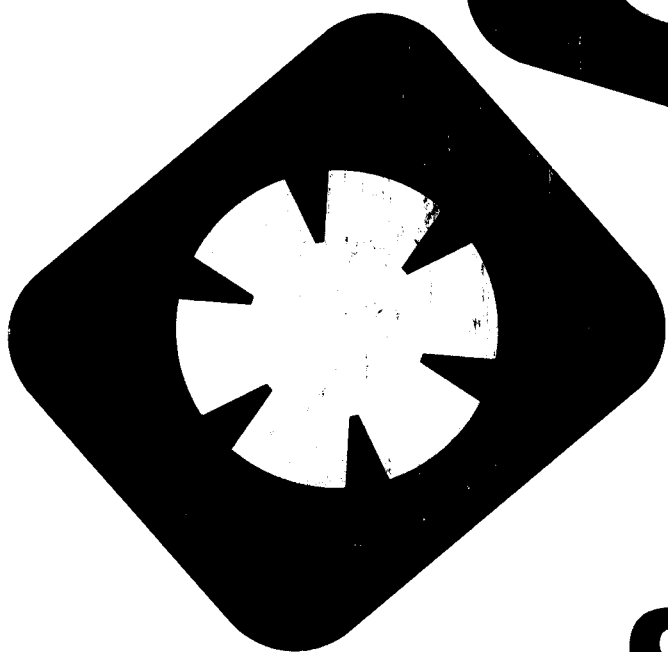
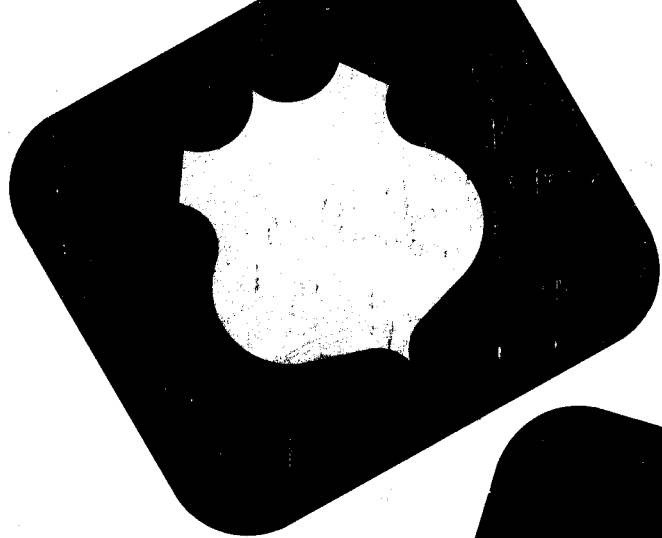
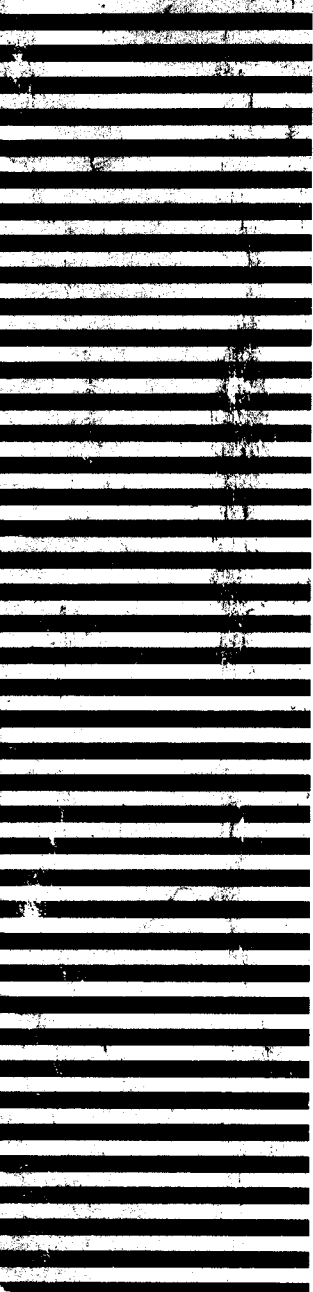

**SX-V**